



# 向心关节轴承 Radial Spherical Plain Bearings



滑动摩擦副：钢 / 钢

Sliding contact surfaces: Steel / Steel

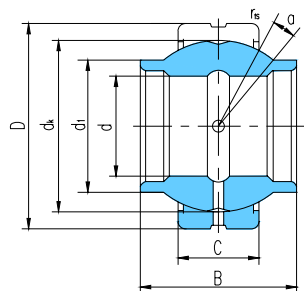

轴承 型号 Bearing number	外形尺寸 Dimensions									额定载荷 Load ratings		重量 Weight ≈kg
	mm									kN		
	d	D	B	C	d <sub>1</sub> max	d <sub>k</sub>	r <sub>s</sub> min	r <sub>1s</sub> min	α° ≈	动载荷 Dynamic	静载荷 Static	
GEEM20ES-2RS	20	35	24	12	24	29	0.3	0.3	6	30	146	0.072
GEEM25ES-2RS	25	42	29	16	29	35.5	0.3	0.6	4	48	240	0.13
GEEM30ES-2RS	30	47	30	18	34	40.7	0.3	0.6	4	62	310	0.16
GEEM35ES-2RS	35	55	35	20	40	47	0.6	1	4	79	399	0.25
GEEM40ES-2RS	40	62	38	22	45	53	0.6	1	4	99	495	0.34
GEEM45ES-2RS	45	68	40	25	52	60	0.6	1	4	127	637	0.45
GEEM50ES-2RS	50	75	43	28	57	66	0.6	1	4	156	780	0.59
GEEM60ES-2RS	60	90	54	36	68	80	0.6	1	3	245	1220	1.06
GEEM70ES-2RS	70	105	65	40	78	92	0.6	1	4	313	1560	1.66
GEEM80ES-2RS	80	120	74	45	90	105	0.6	1	4	400	2000	2.47
GEEM90ES-2RS	90	130	80	50	99	115	1	1	4	488	2440	2.88
GEEM100ES-2RS	100	150	90	55	113	130	1	1	4	607	3030	4.65
GEEM120ES-2RS	120	180	108	70	133	160	1	1	4	950	4750	8.44