



向心关节轴承 Radial Spherical Plain Bearings



滑动摩擦副：钢 / 钢

Sliding contact surfaces: Steel / Steel

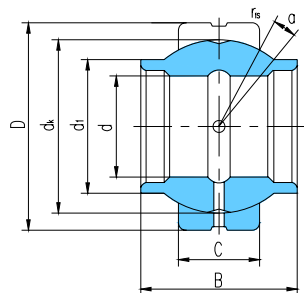

轴承 型号 Bearing number	外形尺寸 Dimensions									额定载荷 Load ratings		重量 Weight ≈ kg
	d	D	B	C	d _i max	d _k	r _s min	r _{1s} min	α° ≈	动载荷 Dynamic	静载荷 Static	
GEEW12ES*	12	22	12	7	15.5	18	0.3	0.3	4	10	53	0.017
GEEW15ES	15	26	15	9	18.5	22	0.3	0.3	5	16	84	0.028
GEEW16ES	16	28	16	9	20	23	0.3	0.3	4	17	85	0.034
GEEW17ES	17	30	17	10	21	25	0.3	0.3	7	21	106	0.043
GEEW20ES	20	35	20	12	25	29	0.3	0.3	4	30	146	0.069
GEEW25ES	25	42	25	16	30.5	35.5	0.6	0.6	4	48	240	0.124
GEEW30ES	30	47	30	18	34	40.7	0.6	0.6	4	62	310	0.159
GEEW32ES	32	52	32	18	37	43	0.6	1	4	65	328	0.207
GEEW35ES	35	55	35	20	40	47	0.6	1	4	79	399	0.248
GEEW40ES	40	62	40	22	46	53	0.6	1	4	99	495	0.349
GEEW45ES	45	68	45	25	52	60	0.6	1	4	127	637	0.468
GEEW50ES	50	75	50	28	57	66	0.6	1	4	156	780	0.62
GEEW60ES	60	90	60	36	68	80	1	1	4	245	1220	1.11
GEEW63ES	63	95	63	36	71.5	83	1	1	4	253	1260	1.27
GEEW70ES	70	105	70	40	78	92	1	1	4	313	1560	1.69
GEEW80ES	80	120	80	45	91	105	1	1	4	400	2000	2.55
GEEW90ES	90	130	90	50	99	115	1	1	4	488	2440	3.04
GEEW100ES	100	150	100	55	113	130	1	1	4	607	3030	4.87
GEEW110ES	110	160	110	55	124	140	1	1	4	654	3270	5.53
GEEW125ES	125	180	125	70	138	160	1	1	4	950	4750	8.19
GEEW160ES	160	230	160	80	177	200	1	1	4	1360	6800	15.8
GEEW200ES	200	290	200	100	221	250	1.1	1.1	4	2120	10600	31.7
GEEW250ES	250	400	250	120	317	350	1.1	1.1	4	3750	17800	101
GEEW320ES	320	520	320	160	405	450	1.1	1.1	4	6200	30500	225

*仅外圈有润滑槽孔。A lubrication groove and holes in the outer ring only.

内径 $d \geq \phi 15\text{mm}$ ，可提供带密封圈的向心关节轴承。Can supply spherical plain bearing with two seals for bore diameter $d \geq \phi 15\text{mm}$.