

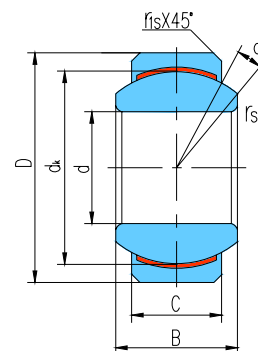

向心关节轴承

Radial Spherical Plain Bearings



滑动摩擦副：钢 / PTFE 复合材料

Sliding contact surfaces: Steel / PTFE composite material

轴承型号 Bearing number	外形尺寸 Dimensions								额定载荷 Load ratings		重量 Weight ≈kg
	d	D	B	C	dk	rs min	ris min	α° ≈	动载荷 Dynamic	静载荷 Static	
GEFZ4C	4.83	14.29	7.14	5.54	10.31	0.3	0.38	11	5.1	12.8	0.006
	0.19	0.5625	0.281	0.218	0.406	0.012	0.015				
GEFZ6C	6.35	16.67	8.71	6.35	12.70	0.3	0.56	13.5	7.2	18.4	0.010
	0.25	0.6562	0.343	0.25	0.5	0.012	0.022				
GEFZ7C	7.94	19.05	9.53	7.14	14.27	0.3	0.81	12	9.1	22.9	0.014
	0.3125	0.75	0.375	0.281	0.562	0.012	0.032				
GEFZ9C	9.53	20.64	10.31	7.92	16.66	0.3	0.81	10	11.8	29.6	0.018
	0.375	0.8125	0.406	0.312	0.656	0.012	0.032				
GEFZ11C	11.11	23.02	11.10	8.71	17.45	0.3	0.81	8	13.6	34.1	0.021
	0.4375	0.9062	0.437	0.343	0.687	0.012	0.032				
GEFZ12C	12.70	25.40	12.70	9.91	20.65	0.3	0.81	9.5	18.4	46	0.029
	0.5	1	0.5	0.39	0.813	0.012	0.032				
GEFZ14C	14.29	27.78	14.27	11.10	23.01	0.3	0.81	9.5	23	57.4	0.042
	0.5625	1.0937	0.562	0.437	0.906	0.012	0.032				
GEFZ15C	15.88	30.16	15.88	12.70	25.40	0.3	0.81	9.5	29	72.5	0.053
	0.625	1.1875	0.625	0.5	1	0.012	0.032				
GEFZ19C	19.05	36.51	19.05	15.06	30.15	0.3	1.12	9	40.8	102.1	0.094
	0.75	1.4375	0.75	0.593	1.187	0.012	0.044				
GEFZ22C	22.23	39.69	22.23	17.86	33.32	0.6	1.12	9.5	53.5	133.8	0.119
	0.875	1.5625	0.875	0.703	1.312	0.024	0.044				
GEFZ25C	25.40	44.45	25.40	20.24	38.10	0.6	1.12	10	69.4	173.5	0.173
	1	1.75	1	0.797	1.5	0.024	0.044				