



向心关节轴承

Radial Spherical Plain Bearings



滑动摩擦副：钢 / 钢

Sliding contact surfaces: Steel / Steel

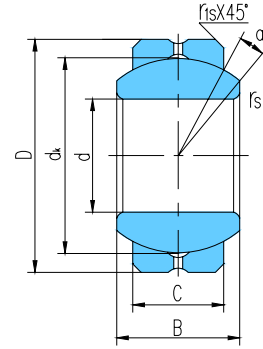

轴承 型号 Bearing number	外形尺寸 Dimensions								额定载荷 Load ratings kN		重量 Weight ≈kg
	d	D	B	C	dk	r _s min	r _s min	α° ≈	动载荷 Dynamic	静载荷 Static	
GEFZ4S	4.83	14.29	7.14	5.54	10.31	0.3	0.38	11	3	15	0.006
	0.19	0.5625	0.281	0.218	0.406	0.012	0.015				
GEFZ6S	6.35	16.67	8.71	6.35	12.70	0.3	0.56	13.5	4.4	22	0.010
	0.25	0.6562	0.343	0.25	0.5	0.012	0.022				
GEFZ7S	7.94	19.05	9.53	7.14	14.27	0.3	0.81	12	6	28	0.014
	0.3125	0.75	0.375	0.281	0.562	0.012	0.032				
GEFZ9S	9.53	20.64	10.31	7.92	16.66	0.3	0.81	10	7.4	37	0.018
	0.375	0.8125	0.406	0.312	0.656	0.012	0.032				
GEFZ11S	11.11	23.02	11.10	8.71	17.45	0.3	0.81	8	8.4	42	0.021
	0.4375	0.9062	0.437	0.343	0.687	0.012	0.032				
GEFZ12S	12.70	25.40	12.70	9.91	20.65	0.3	0.81	9.5	12	58	0.029
	0.5	1	0.5	0.39	0.813	0.012	0.032				
GEFZ14S	14.29	27.78	14.27	11.10	23.01	0.3	0.81	9.5	15	73	0.042
	0.5625	1.0937	0.562	0.437	0.906	0.012	0.032				
GEFZ15S	15.88	30.16	15.88	12.70	25.40	0.3	0.81	9.5	19	94	0.053
	0.625	1.1875	0.625	0.5	1	0.012	0.032				
GEFZ19S	19.05	36.51	19.05	15.06	30.15	0.3	1.12	9	28	141	0.094
	0.75	1.4375	0.75	0.593	1.187	0.012	0.044				
GEFZ22S	22.23	39.69	22.23	17.86	33.32	0.6	1.12	9.5	37	186	0.119
	0.875	1.5625	0.875	0.703	1.312	0.024	0.044				
GEFZ25S	25.40	44.45	25.40	20.24	38.10	0.6	1.12	10	49	245	0.173
	1	1.75	1	0.797	1.5	0.024	0.044				