



# 向心关节轴承

## Radial Spherical Plain Bearings



滑动摩擦副：钢 / PTFE 编织物  
Sliding contact surfaces: Steel / PTFE fabric

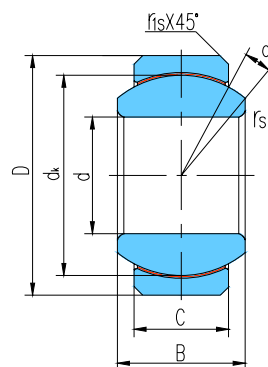

轴承型号 Bearing number	外形尺寸 Dimensions								额定载荷 Load ratings kN		重量 Weight ≈ kg
	d	D	B	C	dk	rs min	r1s min	α° ≈	动载荷 Dynamic	静载荷 Static	
GEFZ4T	4.83	14.29	7.14	5.54	10.31	0.3	0.38	11	7.4	11	0.006
	0.19	0.5625	0.281	0.218	0.406	0.012	0.015				
GEFZ6T	6.35	16.67	8.71	6.35	12.70	0.3	0.56	13.5	10	15	0.010
	0.25	0.6562	0.343	0.25	0.5	0.012	0.022				
GEFZ7T	7.94	19.05	9.53	7.14	14.27	0.3	0.81	12	13	19	0.014
	0.3125	0.75	0.375	0.281	0.562	0.012	0.032				
GEFZ9T	9.53	20.64	10.31	7.92	16.66	0.3	0.81	10	17	25	0.018
	0.375	0.8125	0.406	0.312	0.656	0.012	0.032				
GEFZ11T	11.11	23.02	11.10	8.71	17.45	0.3	0.81	8	19	28	0.021
	0.4375	0.9062	0.437	0.343	0.687	0.012	0.032				
GEFZ12T	12.70	25.40	12.70	9.91	20.65	0.3	0.81	9.5	26	39	0.029
	0.5	1	0.5	0.39	0.813	0.012	0.032				
GEFZ14T	14.29	27.78	14.27	11.10	23.01	0.3	0.81	9.5	33	49	0.042
	0.5625	1.0937	0.562	0.437	0.906	0.012	0.032				
GEFZ15T	15.88	30.16	15.88	12.70	25.40	0.3	0.81	9.5	41	61	0.053
	0.625	1.1875	0.625	0.5	1	0.012	0.032				
GEFZ19T	19.05	36.51	19.05	15.06	30.15	0.3	1.12	9	59	88	0.094
	0.75	1.4375	0.75	0.593	1.187	0.012	0.044				
GEFZ22T	22.23	39.69	22.23	17.86	33.32	0.6	1.12	9.5	89	133	0.119
	0.875	1.5625	0.875	0.703	1.312	0.024	0.044				
GEFZ25T	25.40	44.45	25.40	20.24	38.10	0.6	1.12	10	115	172	0.173
	1	1.75	1	0.797	1.5	0.024	0.044				