



向心关节轴承 Radial Spherical Plain Bearings



滑动摩擦副：钢 / 铜合金

Sliding contact surfaces: Steel / Copper alloy

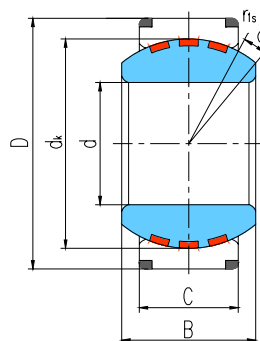

轴承 型号 Bearing number	外形尺寸 Dimensions mm								额定载荷 Load ratings kN		重量 Weight ≈kg
	d	D	B	C	dk	rs min	rls min	α° ≈	动载荷 Dynamic	静载荷 Static	
GEH100XF/Q	100	150	71	67	135	1	1	2	900	1800	4.85
GEH110XF/Q	110	160	78	74	145	1	1	2	1070	2140	5.9
GEH120XF/Q	120	180	85	80	160	1	1	2	1280	2560	8.49
GEH140XF/Q	140	210	100	95	185	1	1	2	1750	3500	14.1
GEH160XF/Q	160	230	115	109	210	1	1	2	2280	4560	17.9
GEH180XF/Q	180	260	128	122	240	1.1	1.1	2	2920	5840	25.9
GEH200XF/Q	200	290	140	134	260	1.1	1.1	2	3480	6960	35.9
GEH220XF/Q	220	320	155	148	290	1.1	1.1	2	4290	8580	48
GEH240XF/Q	240	340	170	162	310	1.1	1.1	2	5020	10040	56
GEH260XF/Q	260	370	185	175	340	1.1	1.1	2	5950	11900	72.8
GEH280XF/Q	280	400	200	190	370	1.1	1.1	2	7030	14060	93.3
GEH300XF/Q	300	430	212	200	390	1.1	1.1	2	7800	15600	114
GEH320XF/Q	320	460	230	218	414	1.1	3	2	9020	18040	144
GEH340XF/Q	340	480	243	230	434	1.1	3	2	9980	19960	158
GEH360XF/Q	360	520	258	243	474	1.1	4	2	11510	23020	207
GEH380XF/Q	380	540	272	258	494	1.5	4	2	12740	25480	230
GEH400XF/Q	400	580	280	265	514	1.5	4	2	13620	27240	283
GEH420XF/Q	420	600	300	280	534	1.5	4	2	14950	29900	312