

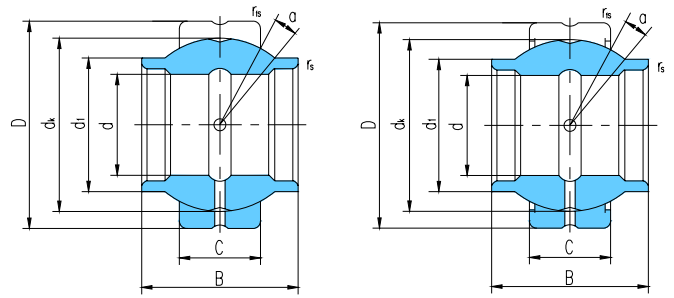

向心关节轴承 Radial Spherical Plain Bearings



滑动摩擦副: 钢 / 钢
Sliding contact surfaces: Steel / Steel



GEWZ...ES

GEWZ...ES-2RS

轴承 型号 Bearing number	外形尺寸 Dimensions									额定载荷 Load ratings		重量 Weight ≈kg
	d	D	B	C	d ₁ max	d _k	r _s min	r _{1s} min	α° ≈	动载荷 Dynamic	静载荷 Static	
GEWZ12ES	12.700	22.225	19.050	9.525	15.875	18	0.15	0.6	5	13	41	0.024
	0.5	0.875	0.75	0.375	0.625	0.709	0.006	0.024				
GEWZ15ES	15.875	26.988	23.800	11.913	19.812	23	0.15	0.6	5	22	65	0.038
	0.625	1.0625	0.937	0.469	0.78	0.906	0.006	0.024				
GEWZ19ES	19.050	31.750	28.575	14.275	23.368	27.5	0.3	0.6	5	31	95	0.064
	0.75	1.25	1.125	0.562	0.92	1.083	0.012	0.024				
GEWZ22ES	22.225	36.513	33.325	16.662	27.178	32	0.3	0.6	5	42	127	0.098
	0.875	1.4375	1.312	0.656	1.07	1.26	0.012	0.024				
GEWZ25ES	25.400	41.275	38.100	19.050	30.988	36.5	0.3	0.6	5	56	166	0.142
	1	1.625	1.5	0.75	1.22	1.437	0.012	0.024				
GEWZ31ES	31.750	50.800	47.625	23.800	38.735	45.5	0.6	0.6	5	86	260	0.271
	1.25	2	1.875	0.937	1.525	1.791	0.024	0.024				
GEWZ34ES	34.925	55.563	52.375	26.187	42.418	49	0.6	1	5	102	310	0.373
	1.375	2.1875	2.062	1.031	1.67	1.929	0.024	0.04				
GEWZ38ES	38.100	61.913	57.150	28.575	46.99	54.7	0.6	1	5	125	375	0.494
	1.5	2.4375	2.25	1.125	1.85	2.154	0.024	0.04				
GEWZ44ES	44.450	71.438	66.675	33.325	54.991	63.9	0.6	1	5	170	510	0.762
	1.75	2.8125	2.625	1.312	2.165	2.516	0.024	0.04				
GEWZ50ES	50.800	80.963	76.200	38.100	62.484	73	0.6	1	5	224	670	1.11
	2	3.1875	3	1.5	2.46	2.874	0.024	0.04				
GEWZ57ES	57.150	90.488	85.725	42.850	70.104	82	0.6	1	5	280	850	1.57
	2.25	3.5625	3.375	1.687	2.76	3.228	0.024	0.04				
GEWZ63ES	63.500	100.013	95.250	47.625	77.724	92	1	1	5	355	1060	2.15
	2.5	3.9375	3.75	1.875	3.06	3.622	0.04	0.04				
GEWZ69ES	69.850	111.125	104.775	52.375	85.852	100	1	1	5	415	1250	2.9
	2.75	4.375	4.125	2.062	3.38	3.937	0.04	0.04				
GEWZ76ES	76.200	120.650	114.300	57.150	93.345	109.5	1	1	5	500	1500	3.59
	3	4.75	4.5	2.25	3.675	4.311	0.04	0.04				
GEWZ82ES	82.550	130.175	123.825	61.900	101.219	119	1	1	5	585	1760	4.69
	3.25	5.125	4.875	2.437	3.985	4.685	0.04	0.04				
GEWZ88ES	88.900	139.700	133.350	66.675	109.22	128	1	1	5	680	2040	5.86
	3.5	5.5	5.25	2.625	4.3	5.039	0.04	0.04				
GEWZ95ES	95.250	149.225	142.875	71.425	116.586	137	1	1	5	780	2360	7.11
	3.75	5.875	5.625	2.812	4.59	5.394	0.04	0.04				
GEWZ101ES	101.600	158.750	152.400	76.200	124.587	146	1	1	5	900	2650	8.56
	4	6.25	6	3	4.905	5.748	0.04	0.04				
GEWZ114ES	114.300	177.800	171.450	85.725	140.335	164.5	1	1	5	1120	3400	12.24
	4.5	7	6.75	3.375	5.525	6.476	0.04	0.04				
GEWZ127ES	127.000	196.850	190.500	95.250	155.705	183	1	1	5	1400	4150	16.63
	5	7.75	7.5	3.75	6.13	7.205	0.04	0.04				
GEWZ152ES	152.400	222.250	209.550	104.775	178.308	207	1	1	5	1730	5200	20.7
	6	8.75	8.25	4.125	7.02	8.15	0.04	0.04				