

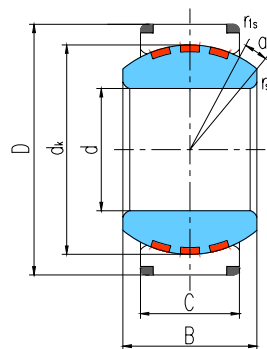

# 向心关节轴承 Radial Spherical Plain Bearings



滑动摩擦副：钢 / 铜合金

Sliding contact surfaces: Steel / Copper alloy

轴承 型号 Bearing number	外形尺寸 Dimensions								额定载荷 Load ratings kN		重量 Weight ≈kg
	d	D	B	C	d <sub>k</sub>	r <sub>s</sub> min	r <sub>1s</sub> min	α° ≈	动载荷 Dynamic	静载荷 Static	
GE100XF/Q	100	150	70	55	130	1	1	7	710	1420	4.24
GE110XF/Q	110	160	70	55	140	1	1	6	770	1540	4.55
GE120XF/Q	120	180	85	70	160	1	1	6	1120	2240	7.77
GE140XF/Q	140	210	90	70	180	1	1	7	1260	2520	10.7
GE160XF/Q	160	230	105	80	200	1	1	8	1600	3200	13.5
GE180XF/Q	180	260	105	80	225	1.1	1.1	6	1800	3600	17.9
GE200XF/Q	200	290	130	100	250	1.1	1.1	7	2500	5000	27.3
GE220XF/Q	220	320	135	100	275	1.1	1.1	8	2750	5500	34.5
GE240XF/Q	240	340	140	100	300	1.1	1.1	8	3000	6000	38.3
GE260XF/Q	260	370	150	110	325	1.1	1.1	7	3570	7140	49.7
GE280XF/Q	280	400	155	120	350	1.1	1.1	6	4200	8400	63
GE300XF/Q	300	430	165	120	375	1.1	1.1	7	4500	9000	75.3
GEC320XF/Q	320	440	160	135	380	1.1	3	4	5130	10260	75.8
GEC340XF/Q	340	460	160	135	400	1.1	3	3	5400	10800	80.8
GEC360XF/Q	360	480	160	135	420	1.1	3	3	5670	11340	84.5
GEC380XF/Q	380	520	190	160	450	1.5	4	4	7200	14400	125
GEC400XF/Q	400	540	190	160	470	1.5	4	3	7520	15040	131
GEC420XF/Q	420	560	190	160	490	1.5	4	3	7840	15680	137
GEC440XF/Q	440	600	218	185	520	1.5	4	3	9620	19240	191
GEC460XF/Q	460	620	218	185	540	1.5	4	3	9990	19980	199